

F

F

E

E

D

D

C

C

B

B

A

A

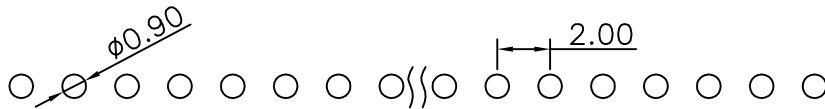
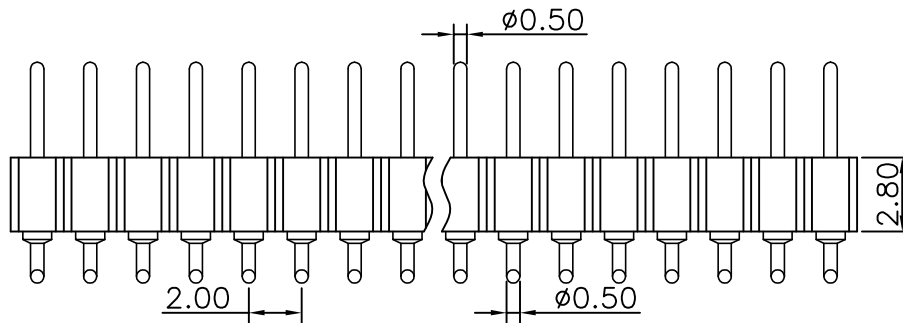
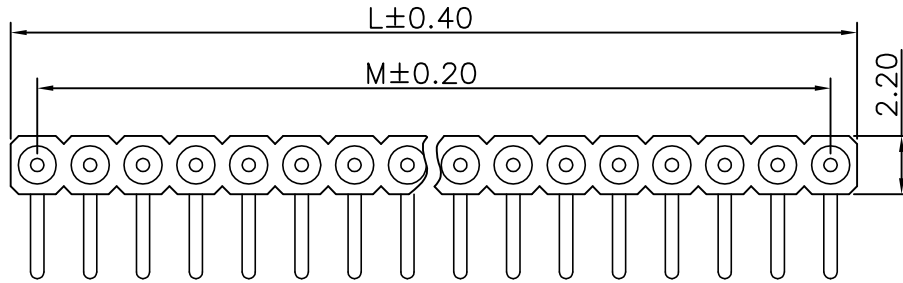

P.C.B LAYOUT

Specifications

Current rating: 3Amps/contact max.

Contact resistance: ≤4mΩ/contact

Insulation resistance: ≥1000MΩ at V=100V

Operating voltage: 60VAC/DC

Operating temperatures: Gold Plated: -55°C to +105°C

Tin plated: -40°C to +105°C

Soldering temperature: +260°C, 10s max

Materials

Contact Material: Brass

Insulation Material: UL94V-0 PPS

All materials must meet GREENCONN

hazardous substances control standards.

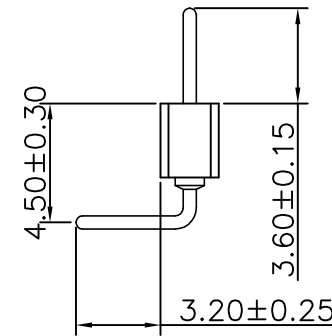

No. of PIN/ROW	M	L
01	0.00	2.00
02	2.00	4.00
03	4.00	6.00
04	6.00	8.00
05	8.00	10.00
06	10.00	12.00
07	12.00	14.00
08	14.00	16.00
09	16.00	18.00
10	18.00	20.00
11	20.00	22.00
12	22.00	24.00
13	24.00	26.00
14	26.00	28.00
15	28.00	30.00
16	30.00	32.00
17	32.00	34.00
18	34.00	36.00
19	36.00	38.00
20	38.00	40.00
21	40.00	42.00
22	42.00	44.00
23	44.00	46.00
24	46.00	48.00
25	48.00	50.00
26	50.00	52.00
27	52.00	54.00
28	54.00	56.00
29	56.00	58.00
30	58.00	60.00
31	60.00	62.00
32	62.00	64.00
33	64.00	66.00
34	66.00	68.00
35	68.00	70.00
36	70.00	72.00
37	72.00	74.00
38	74.00	76.00
39	76.00	78.00
40	78.00	80.60

Ordering Information

G KFB102 - XX XX A 001 S X B X

No. of Pins per Row
01~40

Standard Plating
02=Gold Flash

Color
1=Black

Standard Packing
C=Tube
N=PE bag



Website: www.greenconn.com
E-mail: sales@greenconn.com

REV. A UNIT. mm SCALE. 1:1

3RD. ANG
PROJ.

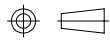

PAGE. 1/1

GENERAL TOLERANCE

X.±5.0°	X.±0.50
.X°±/	.X±0.30
.XX°±/	.XX±0.20
.XXX°±/	.XXX±0.10

DESIGNED:	DATE:
CHECKED:	DATE:
APPROVED:	DATE:

DWG. NO.
GKFB102-CA001SB
PART NO.
GKFB102-XXXX A001SXBX

TITLE.
2.0mmPitch SIP Sockets
Single Row Right Angle Pin
Length 12.15mm