

1 2 3 4 5 6 7 8 9

F  
E  
D  
C  
B  
A

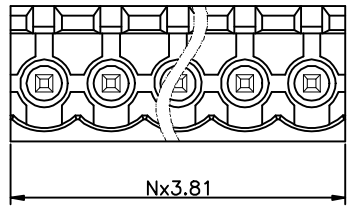

N=Number of contacts

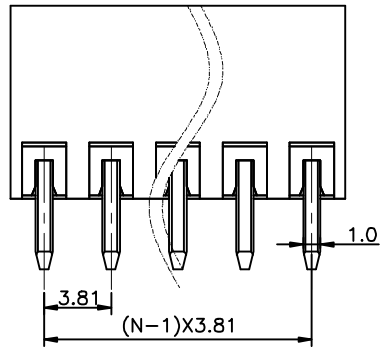

P.C.B. LAYOUT

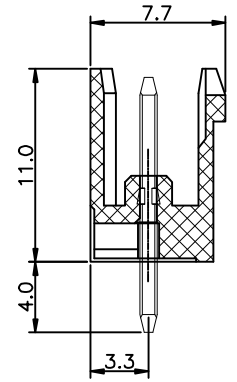
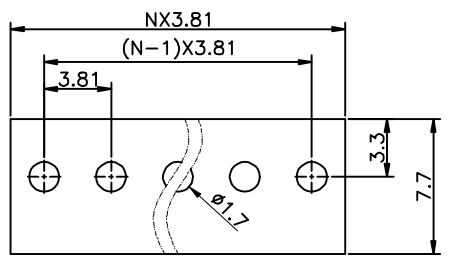

**Specifications**  
 Voltage rating:300VAC  
 Current rating: 12 Amps/way max  
 Contact resistance: 20mΩ(max)  
 Insulation resistance: 5000MΩ/1000V  
 Withstanding Voltage: 2500VAC(1min)Test time:60sec/1pcs  
**Mechanical:**  
 Torque:/  
 Operating temperature:-40°C to +105°C  
**Materials**  
 Contact Material:Brass  
 Insulator Material: UL 94V-0 PA66  
 All materials must meet GREENCONN hazardous substances control standards.

**Ordering Information**

GXZA101 - XX XX A 015 E X B X  
 No.of Pins Per Row 02~24      Standard Plating 01=Tin      Color 1=Black 7=Blue G=Green      Standard Packing R=Cartons

 Website:www.greenconn.com E-mail:sales@greenconn.com	3RD.ANG PROJ.	GENERAL TOLERANCE		DESIGNED:	DATE:	DWG. NO.	TITLE.
	 PAGE. 1/1	X.±5.0'	X.±0.50	CHECKED:	DATE:	GXZA101-CA015EB	Pitch3.81mm-Open-180'-series
REV. A	UNIT. mm	SCALE. 1:1	.X'±3.0'	.X±0.30	APPROVED:	DATE:	
			.XX'±2.0'	.XX±0.20			GXZA101-XXXXA015EXBX
			.XXX'±1.0'	.XXX±/			

1 2 3 4 5 6 7 8 9