

1 2 3 4 5 6 7 8 9

F
E
D
C
B
A

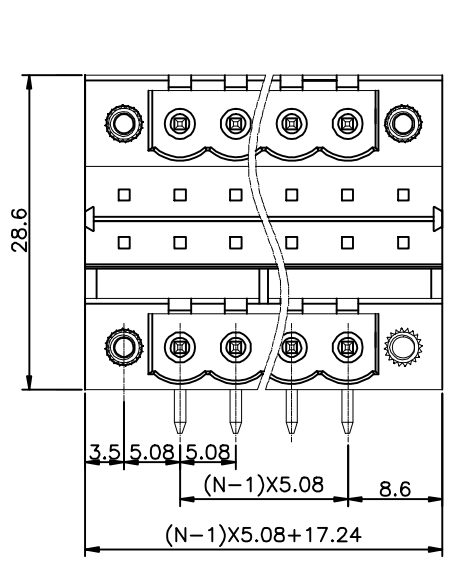

N=Number of contacts

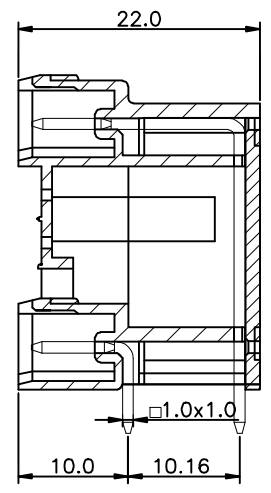

Specifications
 Voltage rating:300V AC
 Current rating:16A
 Contact resistance: 20mΩ(max)
 Insulation resistance: 5000MΩ/1000V
 Withstanding Voltage: AC 2500V(1min)
 Mechanical:
 Torque:/
 Operating temperature:-40°C to+105°C
 Materials
 Contact Material:Brass
 Insulator Material: UL 94V-0 PA66
 All materials must meet GREENCONN hazardous substances control standards.

P.C.B. LAYOUT

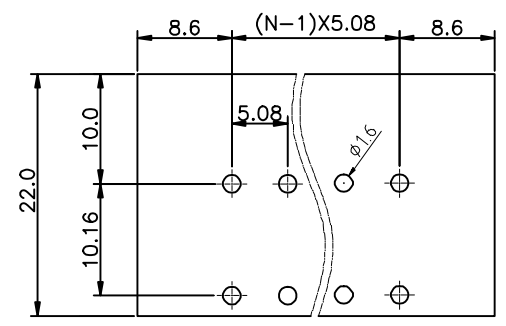
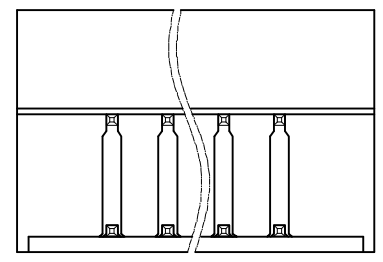

Ordering Information

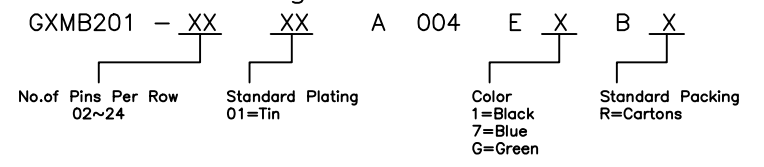

REV. A	UNIT. mm	SCALE. 1:1	PAGE. 1/1
--------	----------	------------	-----------

GENERAL TOLERANCE	
X: ±5.0'	X: ±0.50
.X: ±3.0'	.X: ±0.30
.XX: ±2.0'	.XX: ±0.20
.XXX: ±1.0'	.XXX: ±/

DESIGNED:	DATE:
CHECKED:	DATE:
APPROVED:	DATE:

DWG. NO. GXMB201-CA004EB
PART NO. GXMB201-XXXXA004EXBX

TITLE.
Pitch5.08mm-series

1 2 3 4 5 6 7 8 9