

1 2 3 4 5 6 7 8 9

F

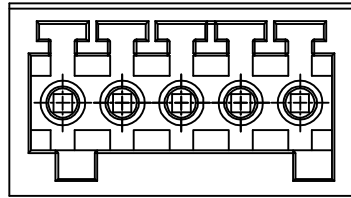

E

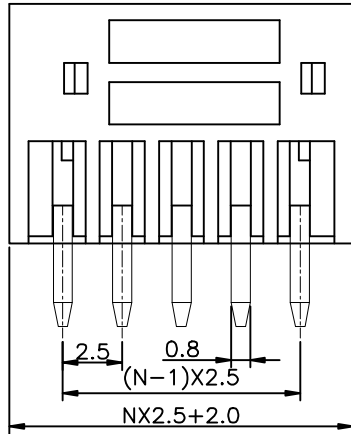

N=Number of contacts

D

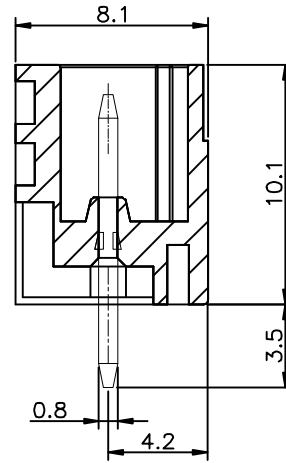

Specifications
 Voltage rating:300VAC
 Current rating: 12 Amps/way max
 Contact resistance: 20mΩ(max)
 Insulation resistance: 5000MΩ/1000V
 Withstanding Voltage: 2500VAC(1min)Test time:60sec/1pcs
 Mechanical:
 Torque:/
 Operating temperature:-40°C to+105°C
 Materials
 Contact Material:Brass
 Insulator Material: UL 94V-0 PA66
 All materials must meet GREENCONN hazardous substances control standards.

C

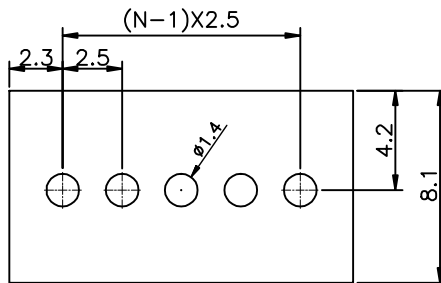

PCB.LAYOUT

B

Ordering Information

GXGA101 - XX XX A 001 E X B X

No.of Pins Per Row 02~24 Standard Plating 01=Tin Color 1=Black 7=Blue G=Green Standard Packing R=Cartons

A

<p>Website:www.greenconn.com E-mail:sales@greenconn.com</p>			3RD.ANG PROJ. 	GENERAL TOLERANCE X.±5.0' X.±0.50 .X'±3.0' .X±0.30 .XX'±2.0' .XX±0.20 .XXX'±1.0' .XXX±/	DESIGNED: CHECKED: APPROVED:	DATE: DATE: DATE:	DWG. NO. GXGA101-CA001EB PART NO. GXGA101-XXXXA001EXBX	TITLE. Pitch 2.5mm-Series
REV. A	UNIT. mm	SCALE. 1:1	PAGE. 1/1					

1 2 3 4 5 6 7 8 9

F

E

D

C

B

A