

1 2 3 4 5 6 7 8 9

F

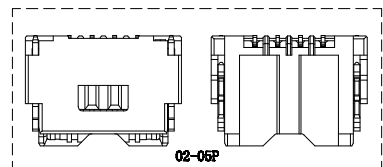
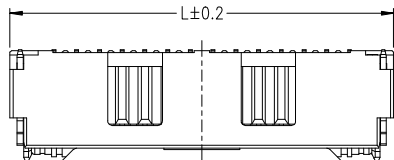

Specifications:  
 Contact resistance: ≤20mΩ  
 Insulation resistance: ≥500MΩ  
 Rated voltage: 100V AC DC  
 Rated current: 2.0A AC DC (AWG#24)  
 Withstand Voltage: 500V AC/minute  
 Temperature Range: -40°C ~ +105°C  
 Housing: LCP UL94V-0  
 Contacts: Phosphor Bronze  
 Solder Tabs: Brass

E

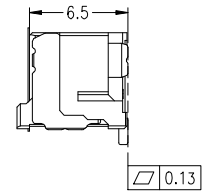
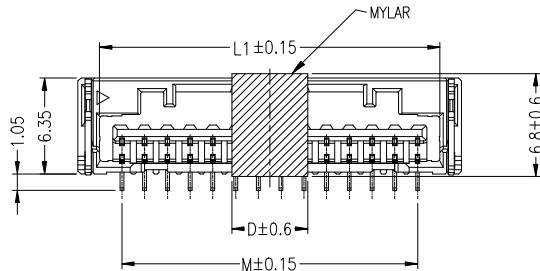

D

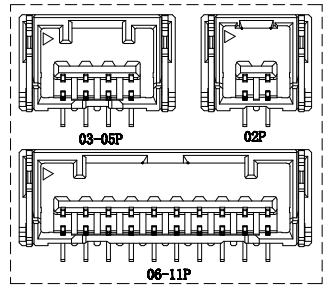
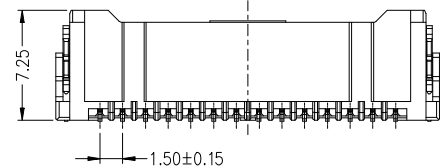

No. of Pins/row	Dimensions				No. of Pins/row	Dimensions			
	L	M	L1	N		L	M	L1	N
2P	7.30	1.50	4.45	6.10	9P	17.80	12.00	14.95	5.00
3P	8.80	3.00	5.95	7.60	10P	19.30	13.50	16.45	5.00
4P	10.3	4.50	7.45	9.10	11P	20.80	15.00	17.95	5.00
5P	11.8	6.00	8.95	10.6	12P	22.30	16.50	19.45	5.00
6P	13.3	7.50	10.45	12.1	13P	23.80	18.00	20.95	5.00
7P	14.80	9.00	11.95	13.60	14P	25.30	19.50	22.45	5.00
8P	16.30	10.50	13.45	5.00	15P	26.80	21.00	23.95	5.00

C

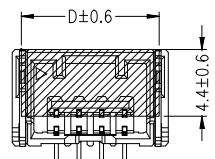
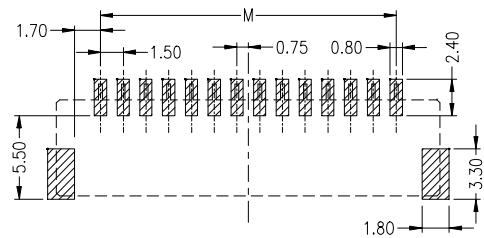

### Ordering Information

G WZC115-XX XX A 002 C X A X

No. of Pins per Row 02~15      Standard Plating 22=Matte Tin      Color 1=Black 2=White 5=Beige  
 Selective Plating 01=Tin      Standard Packing H=Mylar+Tape&Reel      Selective Packing D=Tape&Reel  
 02=Gold Flash

A

 Website: www.greenconn.com E-mail: sales@greenconn.com	3RD. ANG PROJ.	GENERAL TOLERANCE		DESIGNED: CHECKED: APPROVED:	DATE: DATE: DATE:	DWG. NO.	TITLE.
		X'±3.0'	X±0.50			GWZC115-CA002	
	PAGE. 1/1	.X'±2.0'	.X±0.30			PART NO. GWZC115-XXXXA002CXAX	
REV. A	UNIT. mm	SCALE. 1:1	.XX'±1.5'	.XX±0.25			Pitch 1.50mm 180' SMT Wafer
			.XXX'±1.0'	.XXX±0.15			

1 2 3 4 5 6 7 8 9

1 2 3 4 5 6 7 8 9

F

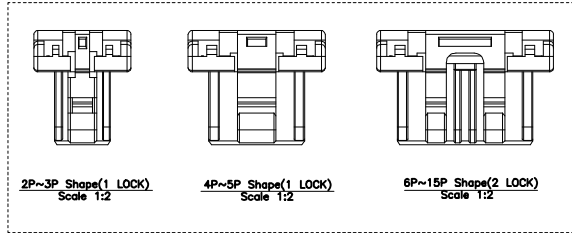
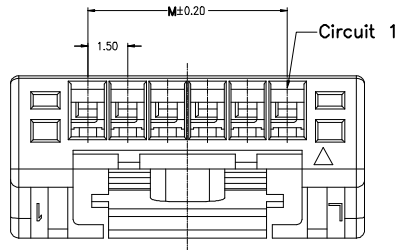

Specifications:  
 Housing:PBT UL94V-0:Color:Nature  
 Contact resistance:20mΩ Max  
 Insulation resistance:500VΩ Min  
 Rated voltage:100V AC/DC  
 Rated current:2A AC/DC  
 Withstand Voltage:500V AC/minute  
 Temperature Range:-25°C~+85°C  
 All materials must meet GREENCONN  
 hazardous substances control standards.

E

D

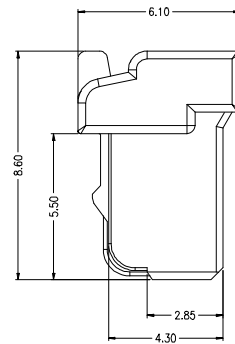
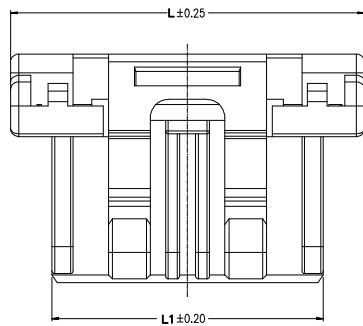

### Ordering Information

GWZ251 - XX A XX

No. of Pins/Row  
02~15

Material/Color  
E=PBT/White

C

B

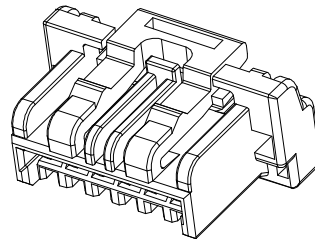
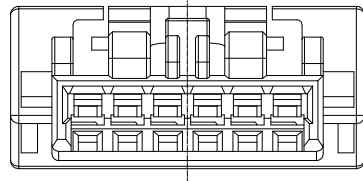

No. of Pins/Row	Dimension Information		
	L	M	L1
02	1.50	7.30	4.20
03	3.00	8.80	5.70
04	4.50	10.30	7.20
05	6.00	11.80	8.70
06	7.50	13.30	10.20
07	9.00	14.80	11.70
08	10.50	16.30	13.20
09	12.00	17.80	14.70
10	13.50	19.30	16.20
11	15.00	20.80	17.70
12	16.50	22.30	19.20
13	18.00	23.80	20.70
14	19.50	25.30	22.20
15	21.00	26.80	23.70

A

**Greenconn**  
 Website:www.greenconn.com  
 E-mail:sales@greenconn.com

REV.	UNIT.	SCALE.
A	mm	1:1

3RD.ANG  
PROJ.  
  
PAGE. 1/1

GENERAL TOLERANCE	
X.±3.0'	X.±0.50
.X'±2.0'	.X±0.30
.XX'±1.0'	.XX±0.20
.XXX'±0.5'	.XXX±0.10

DESIGNED:  
CHECKED:  
APPROVED:

DATE:  
DATE:  
DATE:

DWG. NO.  
GWZ251-HA

PART NO.  
GWZ251-XX A X

TITLE.  
Pitch1.5 Housing

AQ

1 2 3 4 5 6 7 8 9

1 2 3 4 5 6 7 8 9

F  
E  
D  
C  
B  
A

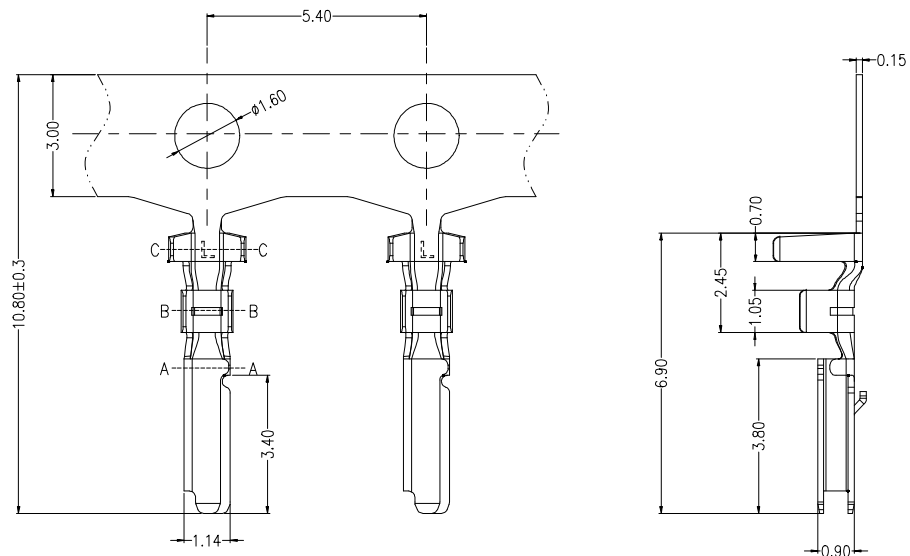

**Specifications**  
 Contact resistance:20mΩ Max  
 Insulation resistance:500MΩ Min  
 Rated voltage:100V AC DC  
 Rated current:2.0A AC DC  
 Withstand Voltage: 500V AC/minute  
 Temperature Range:-40°C~ +105°C  
 Wire Rang: AWG#24~#28  
 Insulation O.D. : 1.28mm(Max)  
 Contacts;Phosphor Bronze  
 All materials must meet Greenconn hazardous substances control standards.

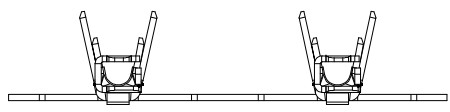

SECTION A-A

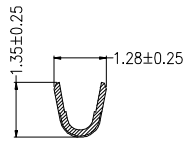

SECTION B-B

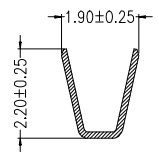

SECTION C-C

### Ordering Information

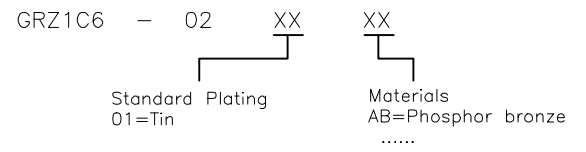

<p>Website:www.greenconn.com E-mail:sales@greenconn.com</p>			3RD.ANG PROJ.		GENERAL TOLERANCE		DESIGNED:	DATE:	DWG. NO.	TITLE.
					X:±5'	X.±0.50				
REV.	UNIT.	SCALE.	PAGE.	.X'±2'	.X±0.30	APPROVED:	DATE:	GRZ1C6-T2	GRZ1C6-02XXAB	
A	mm	1:1	1/1	.XX'±1'	.XX±0.20					
				.XXX'±/'	.XXX±/'					

1 2 3 4 5 6 7 8 9