

1 2 3 4 5 6 7 8 9

F

E

D

C

B

A

F

E

D

C

B

A

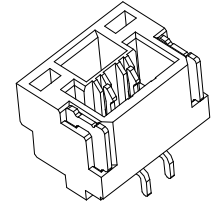
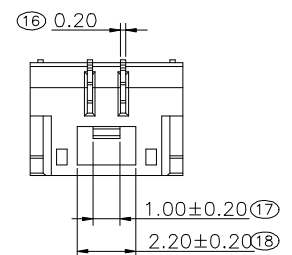
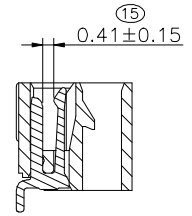
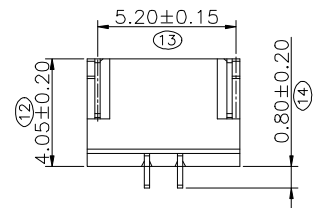
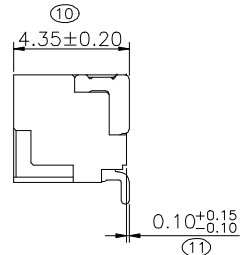
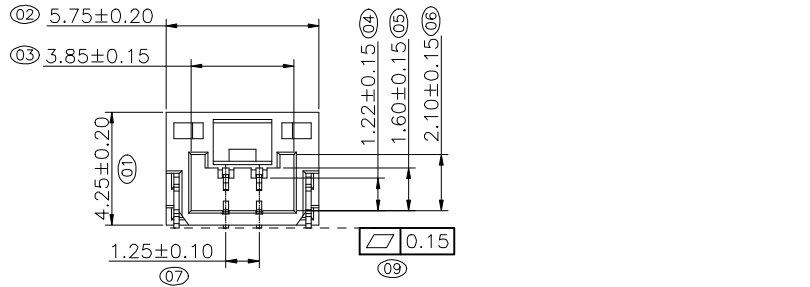

Specifications  
 Current Rating:AWG26:1.0Amp  
 AWG28:1.0Amp  
 AWG30:1.0Amp  
 Voltage Rating: 50V AC/DC.  
 Insulation Resistance:100MΩ Min.  
 Dielectric Withstanding Voltage:500V AC  
 Contact Resistance:30mΩ Max.  
 Operating Temperature:-25°C to +85°C  
 Materials  
 Contact Material:Phosphor Bronze  
 Insulator Material:High Temperature  
 Thermoplastic, UL 94V-0 or the  
 equivalent material  
 All materials must meet GREENCONN  
 hazardous substances control standards.

Recommended P.C.Board  
 Layout  
 (Tolerance:±0.05)

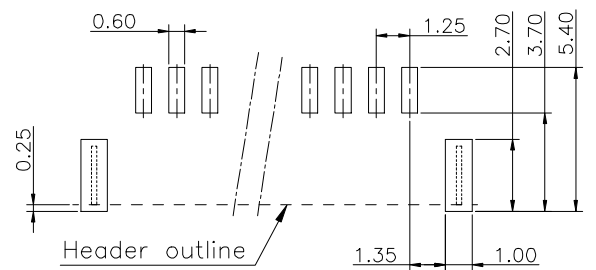

Ordering Information

G PDD101 - XX XX A 001 J X A X  
 No. of Pins per Row 02  
 Standard Plating 01=Ni 50~100u"  
 Tin 80~160u"  
 Color U=natural(ivory)  
 Standard Packing D=Reel  
 F=Reel+CAP  
 H=Reel+Acetate tape

<p>Website:www.greenconn.com E-mail:sales@greenconn.com</p>			3RD.ANG PROJ. 	GENERAL TOLERANCE X.'±5.0' X.±0.30 .X'±3.0' .X±0.25 .XX'±2.0' .XX±0.15 .XXX'±1.0' .XXX±0.10		DESIGNED: CHECKED: APPROVED:	DATE: DATE: DATE:	DWG. NO. GPDD101-CA001 PART NO. GPDD101-02XXA001JUAX	TITLE. 1.25mm PITCH DISCONNECTABLE CRIMP STYLE CONNECTORS
REV. A	UNIT. mm	SCALE. 4:1	PAGE. 1/1						

1 2 3 4 5 6 7 8 9

1 2 3 4 5 6 7 8 9

F

E

D

C

B

A

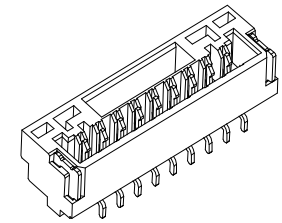
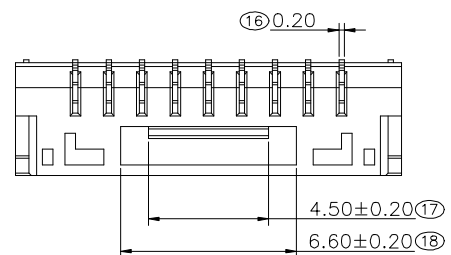
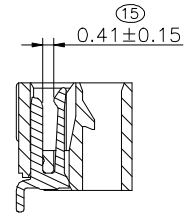
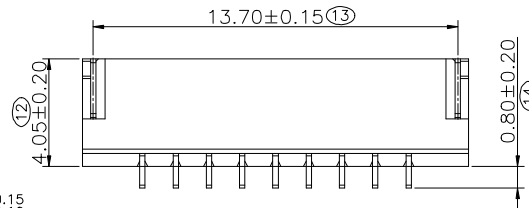
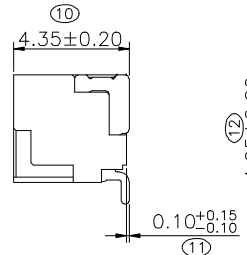
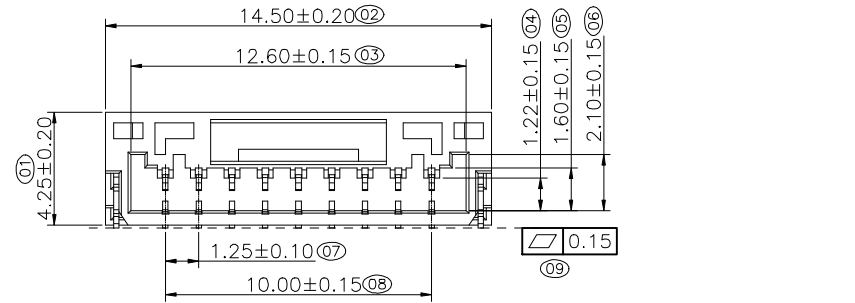

Specifications  
 Current Rating:AWG26:1.0Amp  
 AWG28:1.0Amp  
 AWG30:1.0Amp  
 Voltage Rating: 50V AC/DC.  
 Insulation Resistance:100MΩ Min.  
 Dielectric Withstanding Voltage:500V AC  
 Contact Resistance:30mΩ Max.  
 Operating Temperature:-25°C to +85°C  
 Materials  
 Contact Material:Phosphor Bronze  
 Insulator Material:High Temperature  
 Thermoplastic, UL 94V-0 or the  
 equivalent material  
 All materials must meet GREENCONN  
 hazardous substances control standards.

Recommended P.C.Board  
 Layout  
 (Tolerance:±0.05)

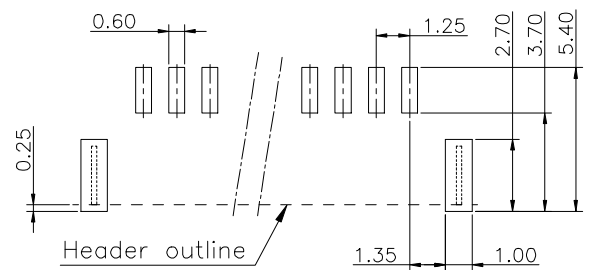

### Ordering Information

G PDD101 - XX XX A 001 J X A X  
 No. of Pins per Row 09  
 Standard Plating 01=Ni 50~100u", Tin 80~160u"  
 Color U=natural(ivory)  
 Standard Packing D=Reel, F=Reel+CAP, H=Reel+Acetate tape

 Website:www.greenconn.com E-mail:sales@greenconn.com			3RD.ANG PROJ.		GENERAL TOLERANCE		DESIGNED:	DATE:	DWG. NO. GPDD101-CA001	TITLE. 1.25mm PITCH DISCONNECTABLE CRIMP STYLE CONNECTORS
					X.'±5.0'	X.±0.30				
REV.	UNIT.	SCALE.	PAGE.			.X'±3.0'	.X±0.25	APPROVED:	DATE:	PART NO. GPDD101-09XXA001JUAX
A	mm	4:1	1/1			.XX'±2.0'	.XX±0.15			
						.XXX'±1.0'	.XXX±0.10			

1 2 3 4 5 6 7 8 9

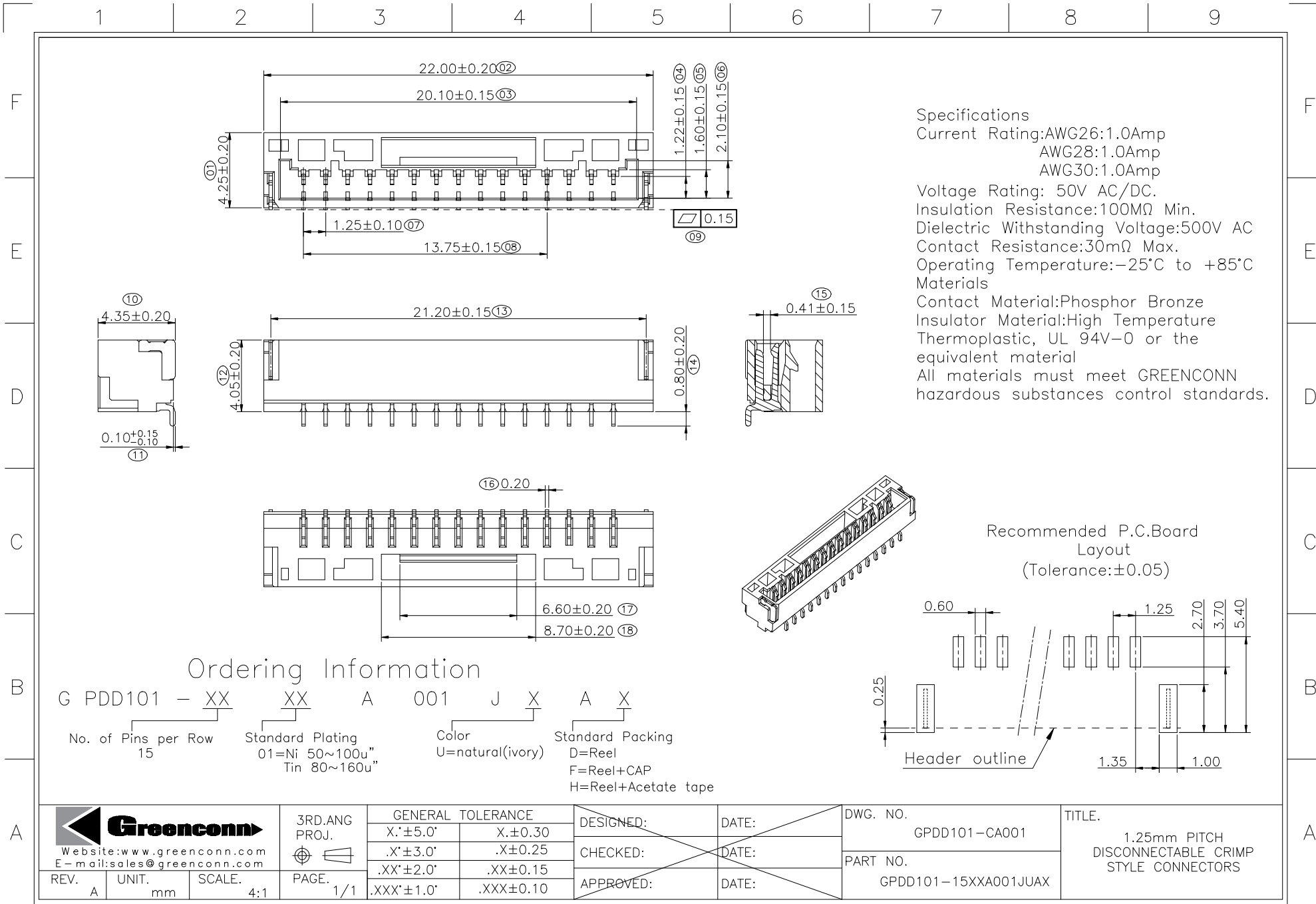

Specifications  
 Current Rating:AWG26:1.0Amp  
                   AWG28:1.0Amp  
                   AWG30:1.0Amp  
 Voltage Rating: 50V AC/DC.  
 Insulation Resistance:100MΩ Min.  
 Dielectric Withstanding Voltage:500V AC  
 Contact Resistance:30mΩ Max.  
 Operating Temperature:-25°C to +85°C  
 Materials  
 Contact Material:Phosphor Bronze  
 Insulator Material:High Temperature  
 Thermoplastic, UL 94V-0 or the  
 equivalent material  
 All materials must meet GREENCONN  
 hazardous substances control standards.

Ordering Information

G PDD101 - XX XX A 001 J X A X  
 No. of Pins per Row 15  
 Standard Plating 01=Ni 50~100u"  
                           Tin 80~160u"  
 Color U=natural(ivory)  
 Standard Packing D=Reel  
                           F=Reel+CAP  
                           H=Reel+Acetate tape

 Website:www.greenconn.com E-mail:sales@greenconn.com			3RD.ANG PROJ.		DESIGNED:		DATE:		DWG. NO. GPDD101-CA001		TITLE. 1.25mm PITCH DISCONNECTABLE CRIMP STYLE CONNECTORS	
					CHECKED:		DATE:		PART NO. GPDD101-15XXA001JUAX			
REV. A	UNIT. mm	SCALE. 4:1	PAGE. 1/1	GENERAL TOLERANCE X.'±5.0' X.±0.30 .X'±3.0' .X±0.25 .XX'±2.0' .XX±0.15 .XXX'±1.0' .XXX±0.10		APPROVED:		DATE:				