

Recommended P.C.Board
Layout
(Tolerance: ±0.05)

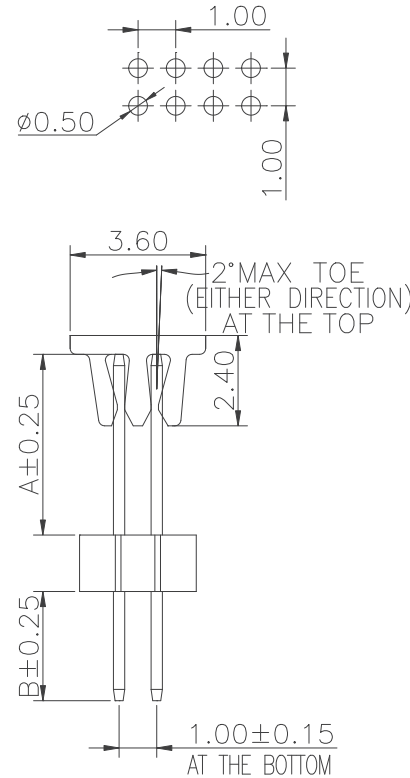

Specifications
Current Rating: 1.0Amp
Insulation Resistance: 1000MΩMin.
Dielectric Withstanding Voltage: 300VAC
Contact Resistance: 20mΩMax.
Operating Temperature: -40°C to +105°C
Materials
Contact Material: Phosphor Bronze
Insulator Material: High Temperature Thermoplastic, UL 94V-0 LCP or the equivalent material
All materials must meet Greenconn hazardous substances control standards.

Dim.E	NOTE
3.00mm	02~04Pins
5.00mm	05~40Pins

No. of PIN/ROW	Dimension Information	
	M	L
02	1.00	2.20
03	2.00	3.20
04	3.00	4.20
05	4.00	5.20
06	5.00	6.20
07	6.00	7.20
08	7.00	8.20
09	8.00	9.20
10	9.00	10.20
11	10.00	11.20
12	11.00	12.20
13	12.00	13.20
14	13.00	14.20
15	14.00	15.20
16	15.00	16.20
17	16.00	17.20
18	17.00	18.20
19	18.00	19.20
20	19.00	20.20
21	20.00	21.20
22	21.00	22.20
23	22.00	23.20
24	23.00	24.20
25	24.00	25.20
26	25.00	26.20
27	26.00	27.20
28	27.00	28.20
29	28.00	29.20
30	29.00	30.20
31	30.00	31.20
32	31.00	32.20
33	32.00	33.20
34	33.00	34.20
35	34.00	35.20
36	35.00	36.20
37	36.00	37.20
38	37.00	38.20
39	38.00	39.20
40	39.00	40.20

Ordering Information

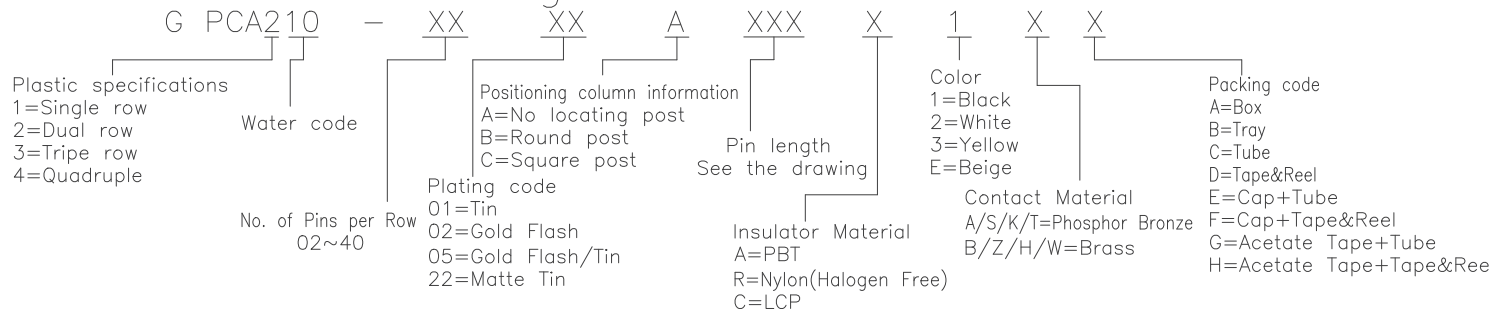

格稜股份有限公司
Greenconn Corporation

GENERAL TOLERANCE	
X.*±5.0°	X.±0.30
.X*±3.0°	.X±0.25
.XX*±2.0°	.XX±0.15
.XXX*±1.0°	.XXX±0.10

DWG. NO.
GPCA210-CAXX
PART NO.
GPCA210-XXXX AXXX X1XX

TITLE.
1.00 PIN HEADER
DUAL ROWS DIP TYPE
CONNECTOR

REV. 01	UNIT. mm	SCALE. 5:1	PAGE. 1/1	
---------	----------	------------	-----------	--