

1 2 3 4 5 6 7 8 9

F

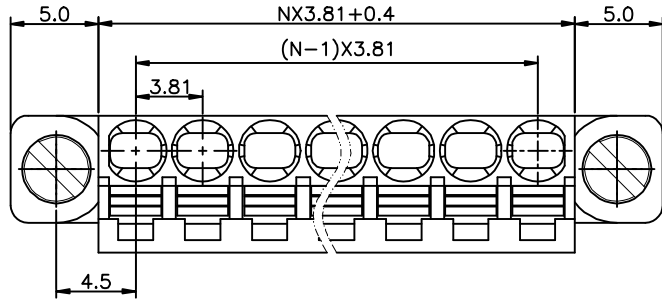

E

D

C

B

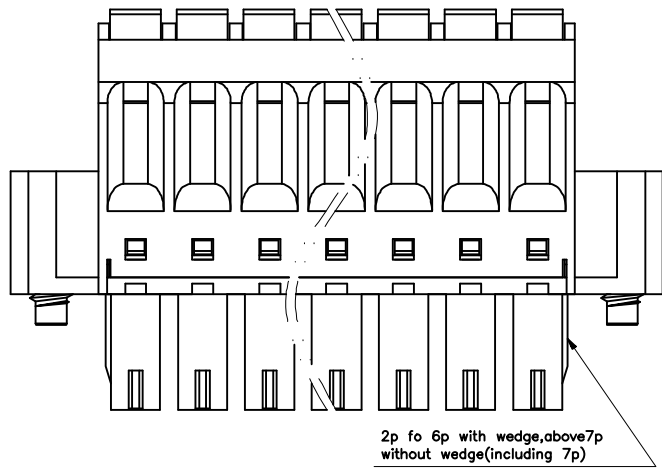

N=Number of contacfs

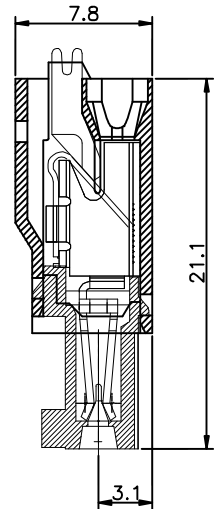

Specifications  
 Voltage rating:300VAC  
 Current rating:12 Amps/way max  
 Contact resistance: 20mΩ(max)  
 Insulation resistance: 5000MΩ/1000V  
 Withstanding Voltage: 2500VAC(1min) Test time:60sec/1pcs  
 Wire range: 16-24AWG  
 Mechanical:  
 Torque:/  
 Operating temperature:-40°C to+105°C  
 Materials  
 Contact Material:Brass  
 Insulator Material: UL 94V-0 PA66  
 All materials must meet GREENCONN hazardous substances control standards.

Ordering Information

CXZZ124 - XX XX A 008 E X B X  
 No.of Pins Per Row 02~24 Standard Plating 01=Tin Color 1=Black 6=Grey 7=Blue G=Green Standard Packing R=Cartons

A



3RD.ANG PROJ.  
 SCALE. 1:1  
 PAGE. 1/1

GENERAL TOLERANCE	
X.±5.0'	X.±0.50
.X'±3.0'	.X±0.30
.XX'±2.0'	.XX±0.20
.XXX'±1.0'	.XXX±/

DESIGNED:  
 CHECKED:  
 APPROVED:

DATE:  
 DATE:  
 DATE:

DWG. NO.  
 CXZZ124-CA008EB  
 PART NO.  
 CXZZ124-XXXXA008EXBX

TITLE.  
 Pitch3.81m-series

1 2 3 4 5 6 7 8 9