

N=Number of contacts

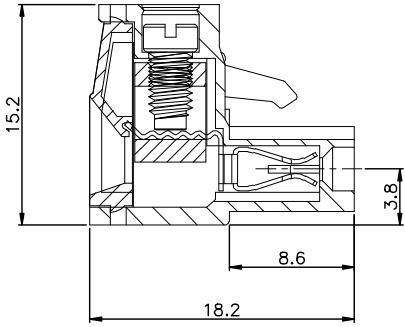

Specifications  
 Voltage rating:300VAC  
 Current rating:16 Amps/way max  
 Contact resistance: 20mΩ(max)  
 Insulation resistance: 5000MΩ/1000V  
 Withstanding Voltage: 2500VAC(1min)  
 Test time:60sec/1pcs  
 wire range: 12-26AWG  
 Mechanical:  
 Torque:5.0kgf.cm/M3  
 Operating temperature:-40°C to+105°C  
 Materials  
 Contact Material:Brass  
 Insulator Material: UL 94V-0 PA66  
 All materials must meet GREENCONN  
 hazardous substances control standards.

### Ordering Information



REV. A	UNIT. mm	SCALE. 1:1	3RD.ANG PROJ.	PAGE. 1/1	GENERAL TOLERANCE		DESIGNED:	DATE:	DWG. NO. CXMZ101-CA005	TITLE. Pitch 5.08mm series
					X.±5.0'	X.±0.50				
					.X'±3.0'	.X±0.30	CHECKED:	DATE:	PART NO. CXMZ101-XXXXA005EXZX	
					.XX'±2.0'	.XX±0.20	APPROVED:	DATE:		
					.XXX'±1.0'	.XXX±/				