

1 2 3 4 5 6 7 8 9

F  
E  
D  
C  
B  
A

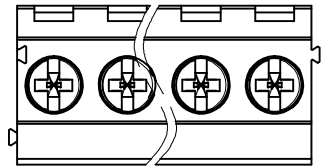

N=Number of contacts

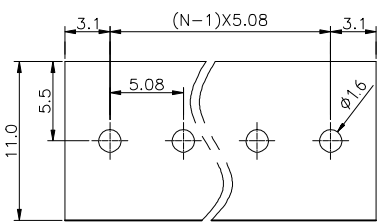
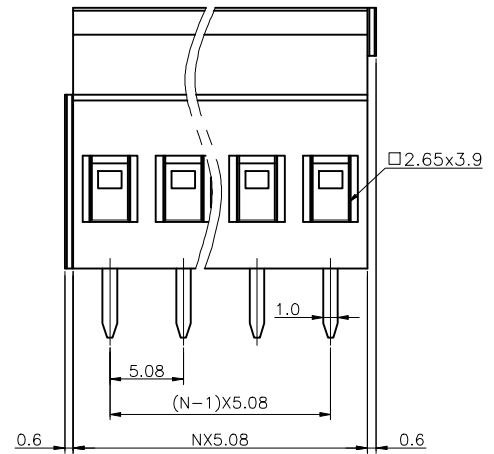

PCB LAYOUT(±0.05)

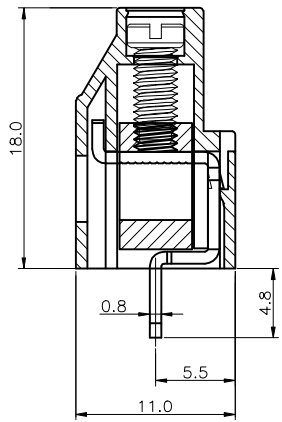

**Specifications**  
 Voltage rating:300VAC  
 Current rating:16 Amps/way max  
 Contact resistance: 20mΩ(max)  
 Insulation resistance: 5000MΩ/1000V  
 Withstanding Voltage: 2500VAC(1min)  
 Test time:60sec/1pcs  
 wire range: 12-30AWG  
**Mechanical:**  
 Torque:4.5kgf.cm/M3  
 Operating temperature:-40°C to+105°C  
**Materials**  
 Contact Material:Brass  
 Insulator Material: UL 94V-0 PA66  
 All materials must meet GREENCONN hazardous substances control standards.

### Ordering Information

C XMB103 - XX XX A 001 E X Z X

No. of Pins per Row 02~24      Standard Plating 01=Tin  
 Color 6=Grey G=Green  
 Standard Packing R=Carton

**Greenconn**  
 Website:www.greenconn.com  
 E-mail:sales@greenconn.com

3RD.ANG PROJ. PAGE. 1/1	GENERAL TOLERANCE			
	X: ±5.0'	X: ±0.50		
	.X: ±3.0'	.X: ±0.30		
	.XX: ±2.0'	.XX: ±0.20		
REV. B	UNIT. mm	SCALE. 1:1	.XXX: ±1.0'	.XXX: ±/

DESIGNED:	DATE:
CHECKED:	DATE:
APPROVED:	DATE:

DWG. NO. CXMB103-CA1EZ
PART NO. CXMB103-XXXXA001EXZX

TITLE.  
F35I-5.08 Series

1 2 3 4 5 6 7 8 9