

1 2 3 4 5 6 7 8 9

F
E
D
C
B
A

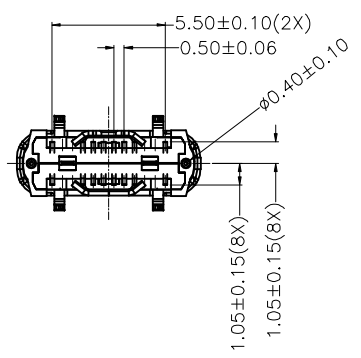
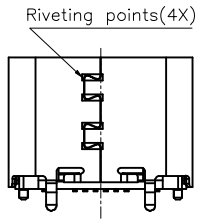
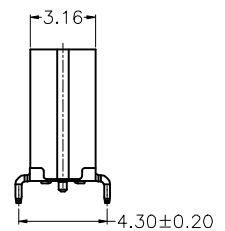
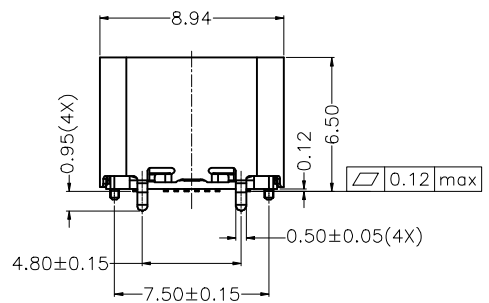
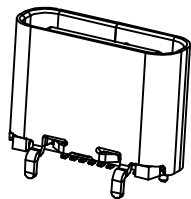
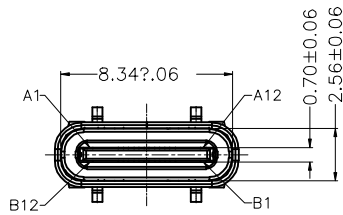

NOTE:

- 1.MATERIAL SPECIFICATION:
 - 1-1.HOUSING: LCP UL94V-0. COLOR:BLACK.
 - 1-2.CONTACTS:COPPER ALLOY(C18150)
 - 1-3.MID PLATE: STAINLESS STEEL(SUS301)
 - 1-4.SHELL: STAINLESS STEEL(SUS304)
- 2.PLATING SPECIFICATION:
 - 2-1.CONTACTS: See part Number
 - 2-2.SHELL: Ni 30u" MIN. UNDER PLATED OVER ALL.
 - 2-3.MID PLATE: CLEAR ONLY
- 3.MECHANICAL PERFORMANCE,
 - 3-1.INSERTION FORCE: 0.5~2.0kgf.
 - 3-2.EXTRACTION FORCE: 0.8kgf~2.0kgf. 0.6kgf~2.0kgf. AFTER DURABILITY TEST.
 - 3-3.DURABILITY: 10000 CYCLES.
- 4.ELECTRICAL PERFORMANCE,
 - 4-1. CURRENT RATING:5.0A VOLTAGE RATING:5.0V
 - 4-2. LLCR: VBUS & GND PINS AND OTHER PINS: 40mΩ/PIN MAX. SHIELD: 50mΩ/MAX. LLCR MAX. CHANGE OF ALL PINS: 10mΩ.
 - 4-3.INSULATION RESISTANCE: 100MΩ MIN
 - 4-4.DIELECTRIC WITHSTAND VOLTAGE,AC 100V FOR 1 MINUTE.
- 5. ENVIRONMENTAL PERFORMANCE: OPERATING TEMPERATURE: -25°C~+85°C.
- 6.IR REFLOW: THE PEAK TEMPERATURE ON THE BOARD SHALL BE MAINTAINED FOR 10 SECONDS AT 260°C.

Ordering Information

C UZC202 - 16 XX B 001 C X 6 X

No. of pins: 16
 Standard Plating: 09=Gold 3u"/Gold Flash, Selective Plating, 08=Gold 5u"/Gold Flash, 14=Gold 30u"/Gold Flash
 Color: 1=Black
 Standard Packing: F=CAP+Tape&Reel, Selective Packing, D=Tape&Reel

 Website: www.greenconn.com E-mail: sales@greenconn.com	3RD.ANG PROJ.	GENERAL TOLERANCE		DESIGNED:	DATE:	DWG. NO. CUZC202-CB1C6	TITLE. USB TYPE C FEMALE 16PIN VERTICAL TYPE SHELL H6.50mm			
	 PAGE. 1/2	X'±5.0'	X.±/					CHECKED:	DATE:	PART NO. CUZC202-16XXB001CX6X
		.X'±3.0'	.X±0.30					APPROVED:	DATE:	
		.XX'±2.0'	.XX±0.25							
REV. A	UNIT. mm	SCALE. 1:1	.XXX'±1.0'	.XXX±0.15						

1 2 3 4 5 6 7 8 9

1 2 3 4 5 6 7 8 9

F

E

D

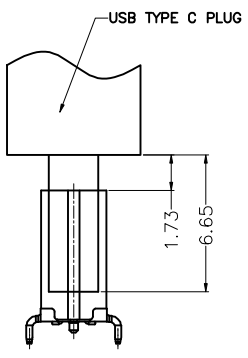
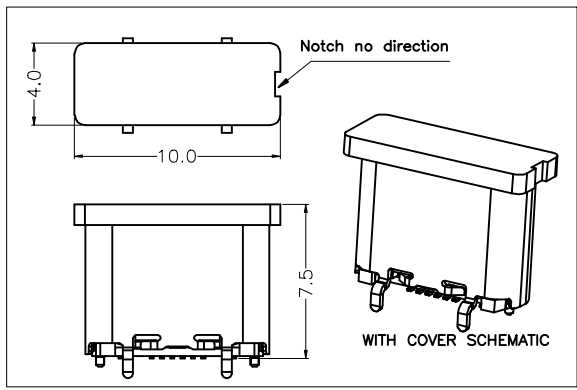

FEMALE AND MALE MATCHING DRAWING

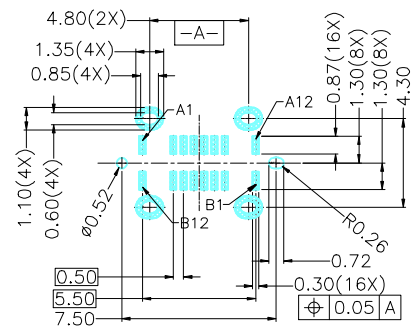

RECOMMENDED PCB LAYOUT(TOP VIEW)
THICKNESS 0.8±0.10MM;DEFAULT TOLERANCE:±0.05

USB TYPE-C PIN ASSIGNMENTS

PIN NUMBER	SIGNAL NAME	PIN NUMBER	SIGNAL NAME
A1	GND	B12	GND
A4	Vbus	B9	Vbus
A5	CC1	B8	SBU2
A6	Dp1	B7	Dn2
A7	Dn1	B6	Dp2
A8	SBU1	B5	CC2
A9	Vbus	B4	Vbus
A12	GND	B1	GND

C

B

A

Greenconn
 Website: www.greenconn.com
 E-mail: sales@greenconn.com

3RD.ANG PROJ.
 UNIT.
 SCALE. 1:1
 PAGE. 2/2

GENERAL TOLERANCE	
X'±5.0'	X.±/
.X'±3.0'	.X±0.30
.XX'±2.0'	.XX±0.25
.XXX'±1.0'	.XXX±0.15

DESIGNED:	DATE:
CHECKED:	DATE:
APPROVED:	DATE:

DWG. NO.
 CUZC202-CB1C6
 PART NO.
 CUZC202-16XXB001CX6X

TITLE.
 USB TYPE C FEMALE 16PIN
 VERTICAL TYPE SHELL H6.50mm

1 2 3 4 5 6 7 8 9

F

E

D

C

B

A