

1 2 3 4 5 6 7 8 9

F
E
D
C
B
A

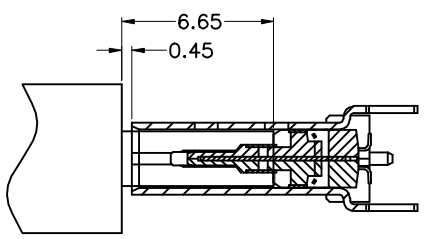

AFTER MATING

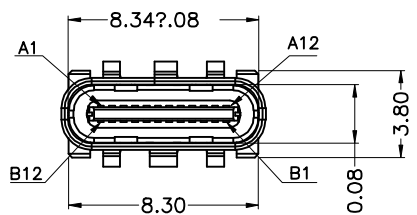
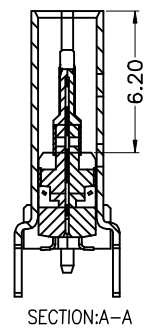
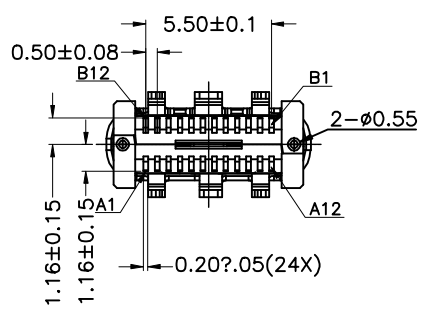
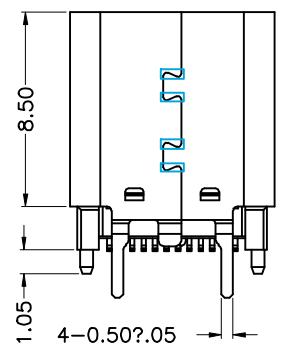
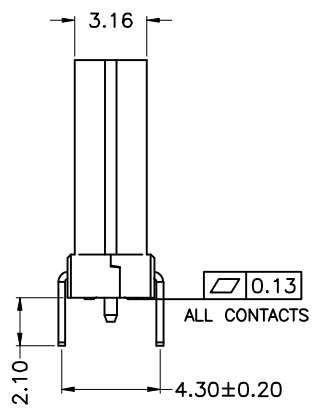
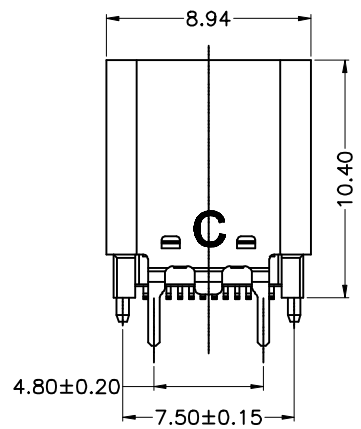

NOTE:

- 1.MATERIAL SPECIFICATION:
 - 1.HOUSING:HIGH TEMPERATURE RESISTANT PLASTIC(LCP),UL94 V-0.
 - 2.CONTACTS:COPPER ALLOY T=0.12mm
 - 3.MID PLATE: STAINLESS STEEL T=0.20mm
 - 4.EMI PLATE: STAINLESS STEEL T=0.10mm
 - 5.SHELL: STAINLESS STEEL T=0.30mm
- 2.PLATING SPECIFICATION:
 - 2-1.CONTACTS:SEE PART NUMBER
 - 2-2.FRONT SHELL&OUTER SHELL: Ni 30u" MIN. UNDER PLATED OVER ALL.
 - 2-3.MID PLATE: CLEAR ONLY
 - 2-4.EMI PLATE: CLEAR ONLY
- 3.MECHANICAL PERFORMANCE,
 - 3-1.INSERTION FORCE: 0.5~2.0kgf.
 - 3-2.EXTRACTION FORCE: 0.8kgf~2.0kgf.
 - 3-3.DURABILITY: 10000 CYCLES.
- 4.ELECTRICAL PERFORMANCE,
 - 4-1. CURRENT RATING:5.0A
VOLTAGE RATING:5.0V
 - 4-2. LLCR: VBUS & GND PINS AND OTHER PINS: 40mΩ/PIN MAX.
SHIELD: 50mΩ/MAX.
LLCR MAX. CHANGE OF ALL PINS: 10mΩ.
 - 4-3.INSULATION RESISTANCE: 100MΩ MIN
 - 4-4.DIELECTRIC WITHSTAND VOLTAGE,AC 100V FOR 1 MINUTE.
5. ENVIRONMENTAL PERFORMANCE:
 - OPERATING TEMPERATURE: -25°C~+85°C.
- 6.IR REFLOW:
 - THE PEAK TEMPERATURE ON THE BOARD SHALL BE MAINTAINED FOR 10 SECONDS AT 260°C.

Ordering Information

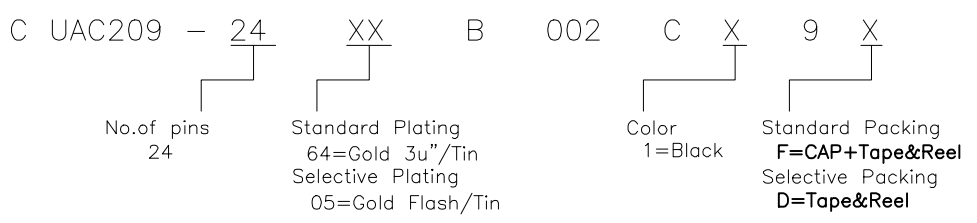

Greenconn
 Website: www.greenconn.com
 E-mail: sales@greenconn.com

3RD.ANG PROJ.

 PAGE. 1/2

GENERAL TOLERANCE	
X'±5.0'	X.±/
.X'±3.0'	.X±0.30
.XX'±2.0'	.XX±0.25
.XXX'±1.0'	.XXX±0.15

DESIGNED:	DATE:
CHECKED:	DATE:
APPROVED:	DATE:

DWG. NO. CUAC209-CB002
 PART NO. CUAC209-24XXB002CX9X

TITLE. USB 3.1 TYPE C FEMALE VERTICAL H=10.4mm SMT TYPE 垂直2.1三次

1 2 3 4 5 6 7 8 9

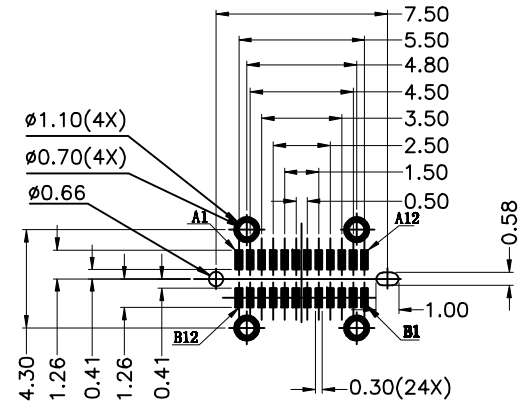
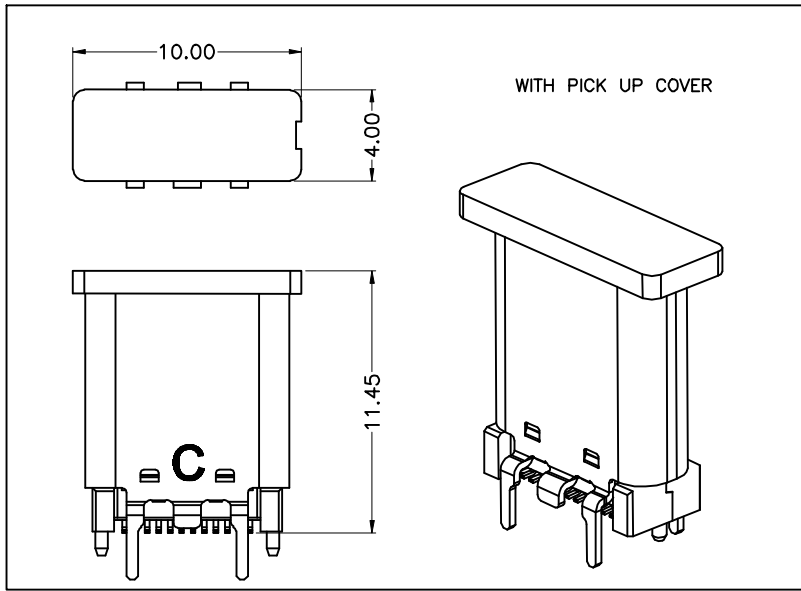

RECOMMENDED PCB LAYOUT(TOP VIEW)
THICKNESS 2.0±.10MM;DEFAULT TOLERANCE:±.05

USB TYPE-C PIN ASSIGNMENTS

PIN NUMBER	SIGNAL NAME	PIN NUMBER	SIGNAL NAME
A1	GND	B12	GND
A2	SSTXp1	B11	SSRXp1
A3	SSTXn1	B10	SSRXn1
A4	Vbus	B9	Vbus
A5	CC1	B8	SBU2
A6	Dp1	B7	Dn2
A7	Dn1	B6	Dp2
A8	SBU1	B5	CC2
A9	Vbus	B4	Vbus
A10	SSRXn2	B3	SSTXn2
A11	SSRXp2	B2	SSTXp2
A12	GND	B1	GND

Greenconn
 Website: www.greenconn.com
 E-mail: sales@greenconn.com

3RD.ANG
 PROJ.

 PAGE. 2/2

GENERAL TOLERANCE	
X'±5.0'	X.±/
.X'±3.0'	.X±0.30
.XX'±2.0'	.XX±0.25
.XXX'±1.0'	.XXX±0.15

DESIGNED:	DATE:
CHECKED:	DATE:
APPROVED:	DATE:

DWG. NO.
 CUAC209-CB002
 PART NO.
 CUAC209-24XXB002CX9X

TITLE.
 USB 3.1 TYPE C FEMALE VERTICAL
 H=10.4mm SMT TYPE 规格2.1三次测量

REV. A

UNIT. mm

SCALE. 1:1