

1 2 3 4 5 6 7 8 9

CAP 示意图

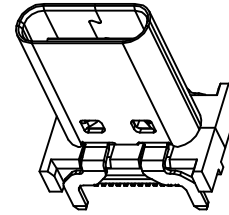
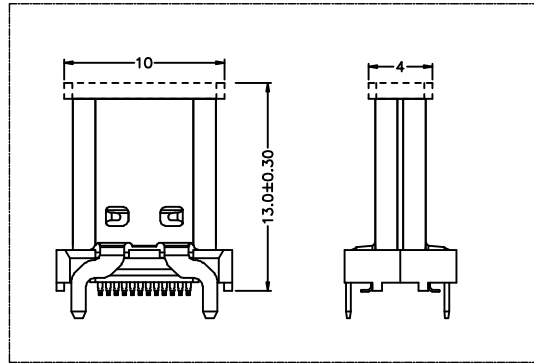
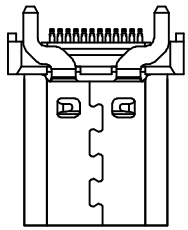

WITHOUT COVER

NOTE:

- 1.Contact Resistance:40mOHM Max.;
- 2.Dielectric Withstanding Voltage:100V AC For 1 Minute;
- 3.Insulation Resistance:100M OHM Min.;
- 4.Mating And Unmating Force:
Mating Force: 5~20N
Unmating Force: 8~20N;
6~20N AFTER TEST;
- 5.Durability:10000 Cycles;

6.MATERIAL:

HOUSING: LCP UL94V-0.
COVER: LCP UL94V-0.
CONTACTS: C7025
SHELL: SUS304
MID PLATE: SUS301
GND Plate: SUS301

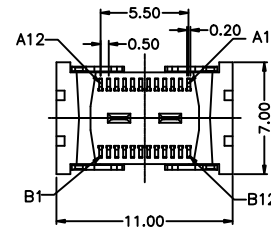
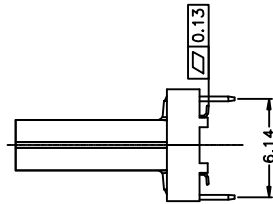
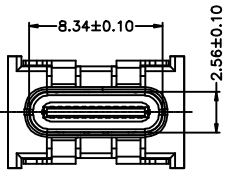

USB TYPE-C PIN ASSIGNMENTS

PIN NUMBER	SIGNAL NAME	PIN NUMBER	SIGNAL NAME
A1	GND	B12	GND
A2	SSTXp1	B11	SSRXp1
A3	SSTXn1	B10	SSRXn1
A4	VBUS	B9	VBUS
A5	CC1	B8	SBU2
A6	Dp1	B7	Dn2
A7	Dn1	B6	Dp2
A8	SBU1	B5	CC2
A9	VBUS	B4	VBUS
A10	SSRXn2	B3	SSTXn2
A11	SSRXp2	B2	SSTXp2
A12	GND	B1	GND

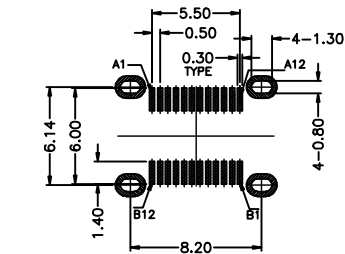
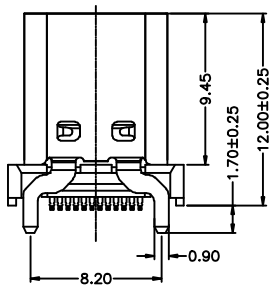

RECOMMEND P.C.B LAYOUT (COMPONENT SIDE)
TOLERANCE FOR PCB LAYOUT IS ± 0.05

Ordering Information

C UAC209 - 24 XX A 001 C X Z X

No. of pins 24 Standard Plating 05=Gold Flash/Tin Selective Plating 75=Gold Flash/Matte Tin Color 1=Black Standard Packing F=CAP+Tape&Reel Selective Packing D=Tape&Reel



Website: www.greenconn.com
E-mail: sales@greenconn.com

REV. A UNIT. mm SCALE. 1:1

3RD.ANG PROJ.
PAGE. 1/1

GENERAL TOLERANCE	
X' ±5.0'	X. ±/
.X' ±3.0'	.X ±0.30
.XX' ±2.0'	.XX ±0.25
.XXX' ±1.0'	.XXX ±0.15

DESIGNED:	DATE:
CHECKED:	DATE:
APPROVED:	DATE:

DWG. NO.
CUAC209-CA001
PART NO.
CUAC209-24XXA001CXZX

TITLE.
USB 3.1 TYPE C FEMALE VERTICAL SMT TYPE

1 2 3 4 5 6 7 8 9