

1 2 3 4 5 6 7 8 9

F

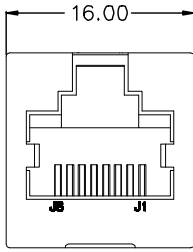

FRONT VIEW

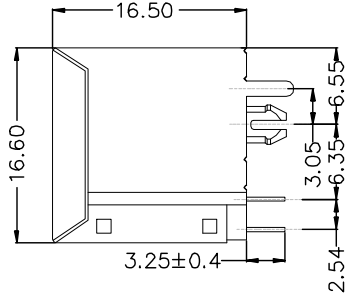

RIGHT SIDE VIEW

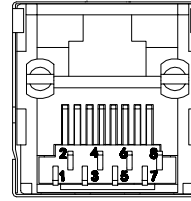

BACK VIEW

MATERIAL:
 HOUSING: PBT,UL94V-0,BLACK.
 TERMINAL: PHOSPHOR BRONZE T=0.35MM
 SHIELD: C2680,T=0.20MM

MACHANICAL:
 DURABILITY: 750 CYCLES MIN,12.5MM/MINUTE.
 INSERTION FORCE: 2.2KG.F MAX.
 RETENTION STRENGTH : 7.7KG.F BETWEEN JACK AND PLUG.
 OPERATING TEMPERATURE: -40°C ~+85°C.
 STORAGE TEMPERATURE: -40°C~+85°C.

ELECTRICAL:
 VOLTAGE: 125 VOLTS AC.
 CURRENT RATING: 1.5AMP.
 DIELECTRIC STRENGTH: 1000 VAC RMS 50HZ OR 60HZ,1MIN.
 INSULATION RESISTANCE: 500 MEGA OHMS MIN. INITIAL
 AFTER 500V DC FOR 1 MINUTE.
 CONTACT RESISTANCE: SINGLE TERMINAL 30 MILLIOHMS MAX.
 INITIAL 50 MILLIOHMS MAX. AFTER
 DURABILITY TEST.

E

D

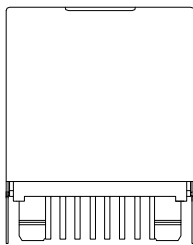

BOTTOM VIEW

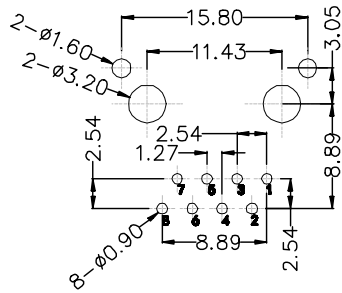

RECOMMENDED PCB LAYOUT
 VIEWED FROM COMPONENT SIDE

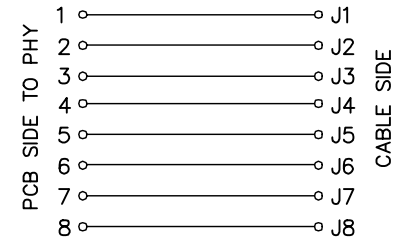

Ordering Information

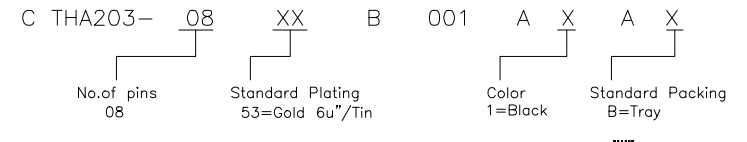

B

A

 Website:www.greenconn.com E-mail:sales@greenconn.com	3RD.ANG PROJ.	GENERAL TOLERANCE		DESIGNED:	DATE:	DWG. NO. CTHA203-CB001	TITLE. RJ45 180° TAB-UP 8P8C
	 PAGE. 1/3	X. 5.0'	X.?.35				
REV. A	UNIT. mm	SCALE. 1:1	.X 3.0'	.X?.30	APPROVED:	DATE:	
			.XX 2.0'	.XX?.25			
			.XXX 1.0'	.XXX?. 15			

1 2 3 4 5 6 7 8 9