

1 2 3 4 5 6 7 8 9

F

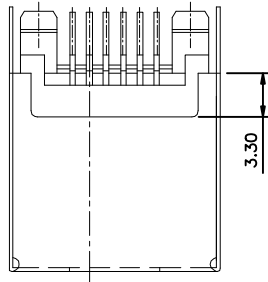

TOP VIEW

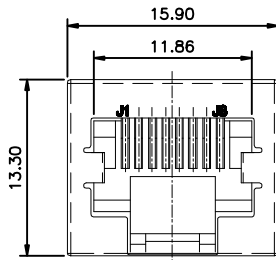

FRONT VIEW

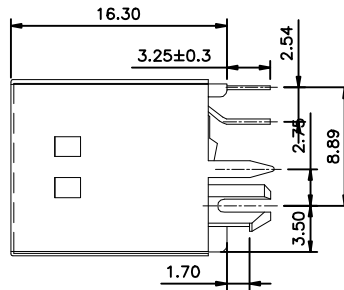

RIGHT SIDE VIEW

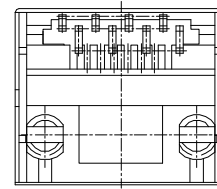

BACK VIEW

D

C

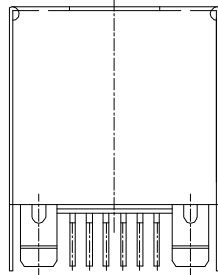

BOTTOM VIEW

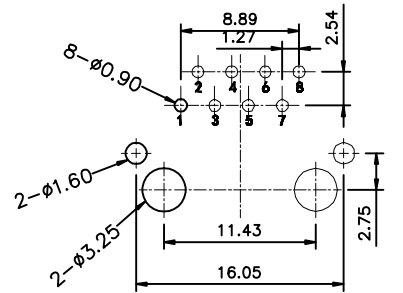

RECOMMENDED PCB LAYOUT VIEWED FROM COMPONENT SIDE

B

A

**Electrical:**  
 Voltage rating:125 Volts AC  
 Insulation resistance:500 megohms minimum initial after 500V DC for 1 minute.  
 Low Level Contact Resistance:Single Terminal 30 milliohms maximum initial 50 milliohms maximum after durability test.  
 Dielectric strength:1000V AC RMS 50Hz 1Min.  
**Mechanical:**  
 Housing :PBT UL94V-0 Black.  
 Plastic brackets PBT UL94V-0,Red  
 Contact Material:phosphor bronze  
 Shell:Brass  
 Durability :750 cycles Min.12.5mm/minute  
 Operating temperature:-40°C~+85°C.  
 Storage temperature:-40°C~+85°C.  
 All materials must meet Greenconn Requirements for environmental protection

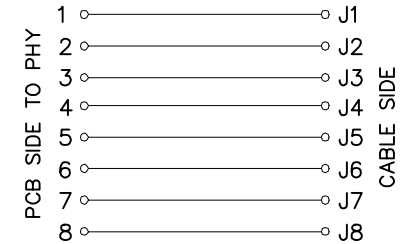

Ordering Information

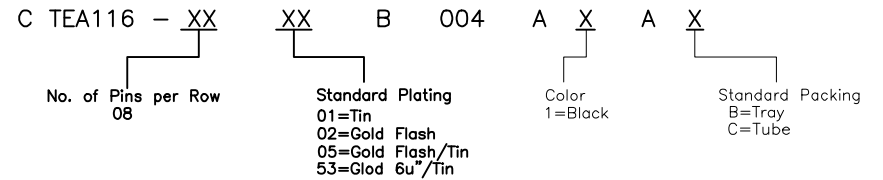

<p>Website:www.greenconn.com E-mail:sales@greenconn.com</p>	3RD.ANG PROJ.	GENERAL TOLERANCE		DESIGNED:	DATE:	DWG. NO. CTEA116-CB004AA	TITLE. RJ45 1*1 8P8C
		X.±5.0'	X.±0.30				
REV. 02	UNIT. mm	SCALE. 1:1	PAGE. 1/1	APPROVED:	DATE:		

1 2 3 4 5 6 7 8 9