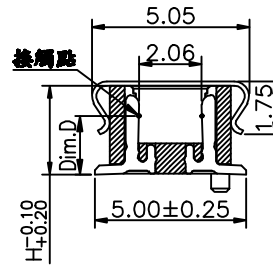
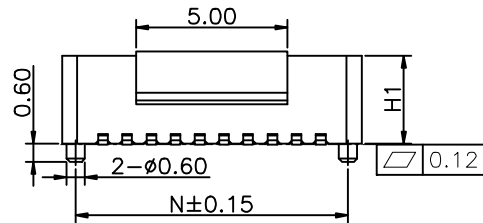

Table:

F/M ASSEM HEIGHT	PART NO.	H1	H	C	Dim.D(Ref)
4.00H	CBBC241-XXXX B001CEAX	2.90	2.95	1.650	1.94
4.50H					
5.00H					
5.50H	CBBC242-XXXX B001CEAX	3.40	3.45	1.650	1.94
6.00H					
6.50H					
7.00H	CBBC243-XXXX B001CEAX	3.90	3.95	1.650	2.44
	CBBC244-XXXX B001CEAX	3.90	3.95	1.250	2.44

Specifications  
 Current Rating:0.5Amp  
 Insulation Resistance:500MΩMin.  
 Dielectric Withstanding Voltage:200VAC  
 Contact Resistance:20mΩMax.  
 Operating Temperature:-40°C to +105°C  
 Materials  
 Contact Material:Phosphor Bronze  
 Insulator Material:High Temperature Thermoplastic, UL 94V-0 Nylon 9T or the equivalent material  
 All materials must meet Greenconn hazardous substances control standards.



Recommended P.C.Board Layout  
 (Tolerance:±0.05)

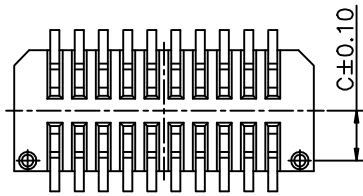
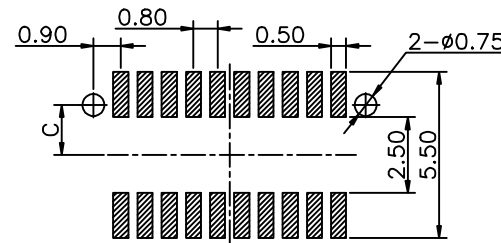

### Ordering Information

CBBC2XX - XX XX B XXX X E A X

Plastic specifications  
 1=Single row  
 2=Dual row  
 3=Tripe row  
 4=Quadruple

Water code  
 See Table

Positioning column information  
 A=No locating post  
 B=Round post

Pin length  
 See the drawing

Color  
 1=Black  
 2=White  
 3=Yellow  
 E=Beige

Packing code  
 C=Tube  
 D=Tape&Reel  
 E=Cap+Tube  
 F=Cap+Tape&Reel

No. of Pins per Row  
 04~25

Plating code  
 01=Tin  
 02=Gold Flash  
 05=Gold Flash/Tin  
 22=Matte Tin

Contact Material  
 A/S/K/T=Phosphor Bronze

Insulator Material  
 C=LCP  
 D=Nylon 9T

No. of PIN/ROW	Dimension Information			
	M	N	L	L1
04	2.40	4.20	5.10	3.60
05	3.20	5.00	5.90	4.40
06	4.00	5.80	6.70	5.20
07	4.80	6.60	7.50	6.00
08	5.60	7.40	8.30	6.80
09	6.40	8.20	9.10	7.60
10	7.20	9.00	9.90	8.40
11	8.00	9.80	10.70	9.20
12	8.80	10.60	11.50	10.00
13	9.60	11.40	12.30	10.80
14	10.40	12.20	13.10	11.60
15	11.20	13.00	13.90	12.40
16	12.00	13.80	14.70	13.20
17	12.80	14.60	15.50	14.00
18	13.60	15.40	16.30	14.80
19	14.40	16.20	17.10	15.60
20	15.20	17.00	17.90	16.40
21	16.00	17.80	18.70	17.20
22	16.80	18.60	19.50	18.00
23	17.60	19.40	20.30	18.80
24	18.40	20.20	21.10	19.60
25	19.20	21.00	21.90	20.40

格稜股份有限公司  
**Greenconn Corporation**

GENERAL TOLERANCE

X.'±5.0'	X.±0.30
.X'±3.0'	.X±0.25
.XX'±2.0'	.XX±0.15
.XXX'±1.0'	.XXX±0.10

DESIGNED:	DATE:
CHECKED:	DATE:
CO SIGEND:	DATE:
APPROVED:	DATE:

DWG. NO.  
 CBBC2XX-CBXX  
 PART NO.  
 CBBC2XX-XXXX BXXX XEAX

TITLE.  
 0.8 PITCH FEMALE BOARD TO BOARD SMT TYPE

REV.	UNIT.	SCALE.	PAGE.
01	mm	6:1	1/1