

INKJET CODE Description: XX X XX XX

XX-YEAR: 20 = 2020
X-MONTH: A = JAN, B = FEB,.....
XX-DAY: 14 = 14th DAY
XX-HOUR: 14 = 14 PM

Specifications

Current Rating 14 AWG: 13.0Amp AC/DC
16 AWG: 13.0Amp AC/DC
18 AWG: 10.0Amp AC/DC
20 AWG: 7.5Amp AC/DC

Voltage Rating: 250V AC/DC.
Insulation Resistance:1000MΩMin.
Dielectric Withstanding Voltage:1500VAC
Contact Resistance:20mΩMax.
Operating Temperature:-55°C to +125°C
Materials

Insulator Material:High Temperature
Thermoplastic, UL 94V-0 PA66
or the equivalent material

★ All materials must meet Greenconn
hazardous substances control standards.

★: Critical Characteristics.
indicates product characteristics,
functionalities, and manufacturing processes
regarding to customer's specifications

★: Safety Features
indicates product characteristics,
functionalities, and manufacturing processes
complying to legal regulations stated by
local government

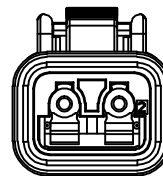
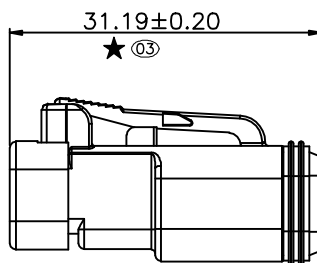
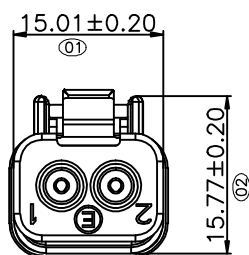

INKJET CODE

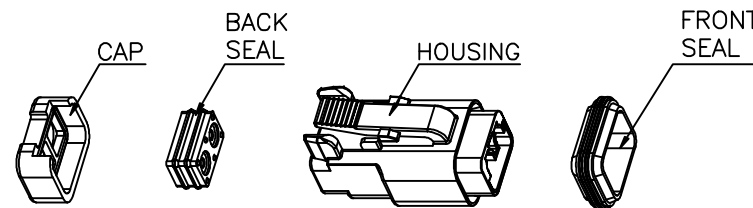
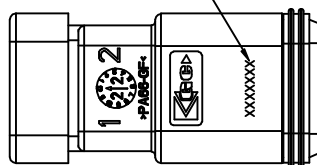

Website:www.greenconn.com
E-mail:sales@greenconn.com

REV. A UNIT. mm SCALE. 3:2

3RD.ANG
PROJ.

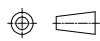

PAGE. 1/1

GENERAL TOLERANCE

X'±3.0'	X.±0.30
.X'±2.0'	.X±0.25
.XX'±1.0'	.XX±0.20
.XXX'±0.5'	.XXX±0.15

DESIGNED:

DATE:

CHECKED:

DATE:

APPROVED:

DATE:

DWG. NO.

AGZ091-HA

PART NO.

AGZ091-02APA

TITLE.

2 WAY PLUG
STANDARD SEAL
SHORT CAP GT SERIES