

Pin Header

pitch 1.27mm (0.05") | Single row | R/A | Board spacer

GPEB135 Series

Specifications

Current Rating : 1.0 Ampere
 Insulation Resistance : 1000 MΩ Min
 Dielectric Withstanding : 300V AC
 Contact Resistance : 20 mΩ Max
 Operating Temperature : -40°C to +105°C

Materials

Contact Material : Brass
 Insulation Material : High Temperature Thermoplastic, 94V-0 LCP

All materials must meet Greenconn's requirements for environmental protection.

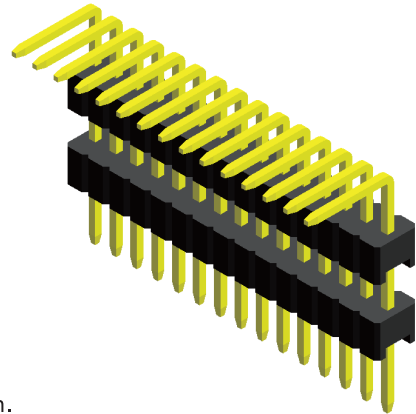

Mating with

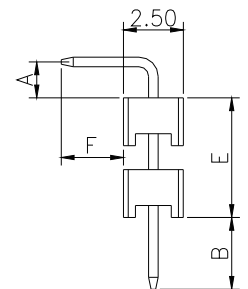
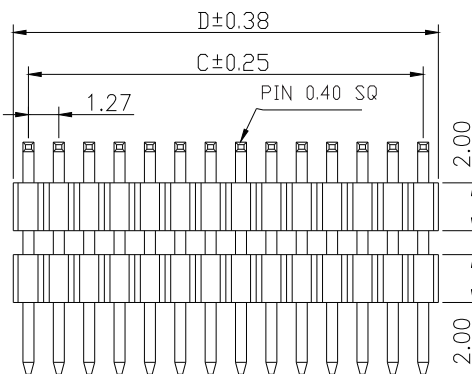
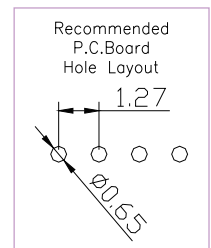
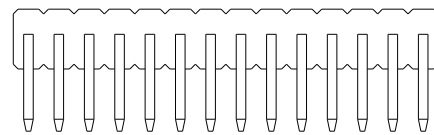
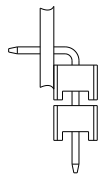
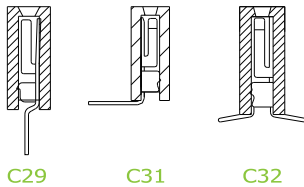

* For Coded Dimension Not Inside The Table, Please Refer To "Ordering Information"

No. of Pins/Row	Dimension Information			No. of Pins/Row	Dimension Information			No. of Pins/Row	Dimension Information			No. of Pins/Row	Dimension Information		
	C	D			C	D			C	D			C	D	
02	1.27	2.54		11	12.70	13.97		21	25.40	26.67		31	38.10	39.37	
03	2.54	3.81		12	13.97	15.24		22	26.67	27.94		32	39.37	40.64	
04	3.81	5.08		13	15.24	16.51		23	27.94	29.21		33	40.64	41.91	
05	5.08	6.35		14	16.51	17.78		24	29.21	30.48					
06	6.35	7.62		15	17.78	19.05		25	30.48	31.75					
07	7.62	8.89		16	19.05	20.32		26	31.75	33.02					
08	8.89	10.16		17	20.32	21.59		27	33.02	34.29					
09	10.16	11.43		18	21.59	22.86		28	34.29	35.56					
10	11.43	12.70		19	22.86	24.13		29	35.56	36.83					
				20	24.13	25.40		30	36.83	38.10					

Ordering Information

Standard Packaging : Tube

GPEB1	<input checked="" type="checkbox"/> <input checked="" type="checkbox"/>	-	<input checked="" type="checkbox"/> <input checked="" type="checkbox"/>	<input checked="" type="checkbox"/> <input checked="" type="checkbox"/>	<input checked="" type="checkbox"/> <input checked="" type="checkbox"/> <input checked="" type="checkbox"/>	C1BC
	Height Option (H)		No. of Pins per Row	Standard Plating	Pin Length (A/B/E/F)	
	<input type="text" value="35"/>		<input type="text" value="02"/>	<input type="text" value="02"/> : Gold Flash	<input type="text" value="002"/> : A=3.70/B=3.50/E=10.0/F=3.70	
			<input type="text" value="33"/>	Selective Plating	<input type="text" value="003"/> : A=3.10/B=3.50/E=6.00/F=3.70	
				<input type="text" value="01"/> : Tin	For special length requirement Please contact our sales personnel	
				<input type="text" value="05"/> : Gold Flash / Tin		