

Female Header

pitch 2.54mm (0.1") | Dual row | Dip

CSHA211 Series

Specifications

Current Rating : 3.0 Ampere
 Insulation Resistance : 1000 MΩ Min
 Dielectric Withstanding : 600V AC
 Contact Resistance : 20 mΩ Max
 Operating Temperature : -40°C to +105°C

Materials

Contact Material : Phosphor Bronze
 Insulation Material : High Temperature Thermoplastic, 94V-0 Nylon

All materials must meet Greenconn's requirements for environmental protection.

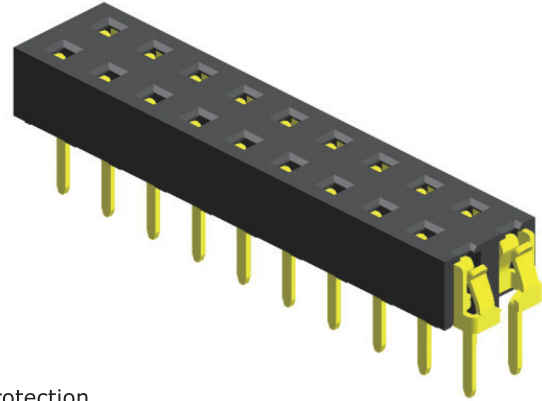

Mating with

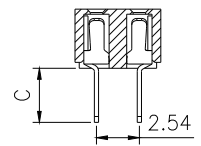
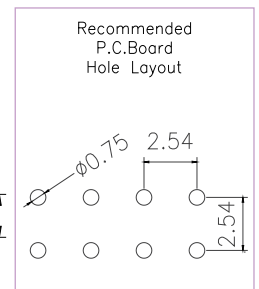
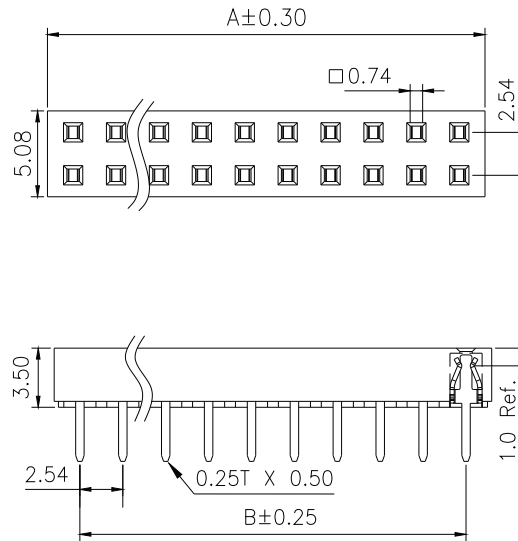
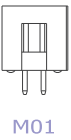
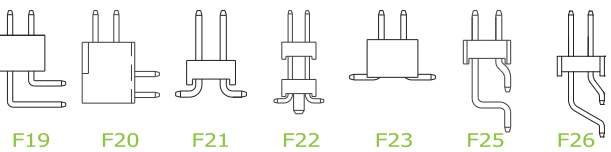
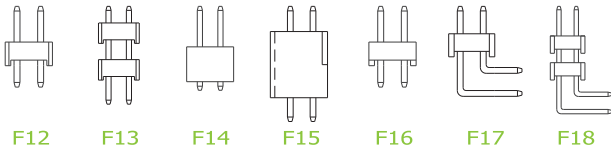

P.S. : Suggested mating pin length : 2.0 ~ 3.0 mm

* For Coded Dimension Not Inside The Table, Please Refer To "Ordering Information"

No. of Pins/Row	Dimension Information			No. of Pins/Row	Dimension Information			No. of Pins/Row	Dimension Information			No. of Pins/Row	Dimension Information		
	A	B			A	B			A	B			A	B	
02	5.58	2.54		11	28.44	25.40		21	53.84	50.80		31	79.24	76.20	
03	8.12	5.08		12	30.98	27.94		22	56.38	53.34		32	81.78	78.74	
04	10.66	7.62		13	33.52	30.48		23	58.92	55.88		33	84.32	81.28	
05	13.20	10.16		14	36.06	33.02		24	61.46	58.42		34	86.86	83.82	
06	15.74	12.70		15	38.60	35.56		25	64.00	60.96		35	89.40	86.36	
07	18.28	15.24		16	41.14	38.10		26	66.54	63.50		36	91.94	88.90	
08	20.82	17.78		17	43.68	40.64		27	69.08	66.04		37	94.48	91.44	
09	23.36	20.32		18	46.22	43.18		28	71.62	68.58		38	97.02	93.98	
10	25.90	22.86		19	48.76	45.72		29	74.16	71.12		39	99.56	96.52	
				20	51.30	48.26		30	76.70	73.66		40	102.10	99.06	

Ordering Information

Standard Packaging : Tube

CSHA2 - R1AC
 Height Option (H) No. of Pins per Row Standard Plating : Gold Flash Pin Length (C) : C=3.10
 : C=3.10
 Selective Plating : Tin For special length requirement Please contact our sales personnel
 : Gold Flash / Tin